

RACORDAREA SAPEI DE PROTECTIE SI FIXAREA GEODRENULUI  
PROTECTION BLANKET FILLET AND GEODREN CONNECTION  
Sc.1:20

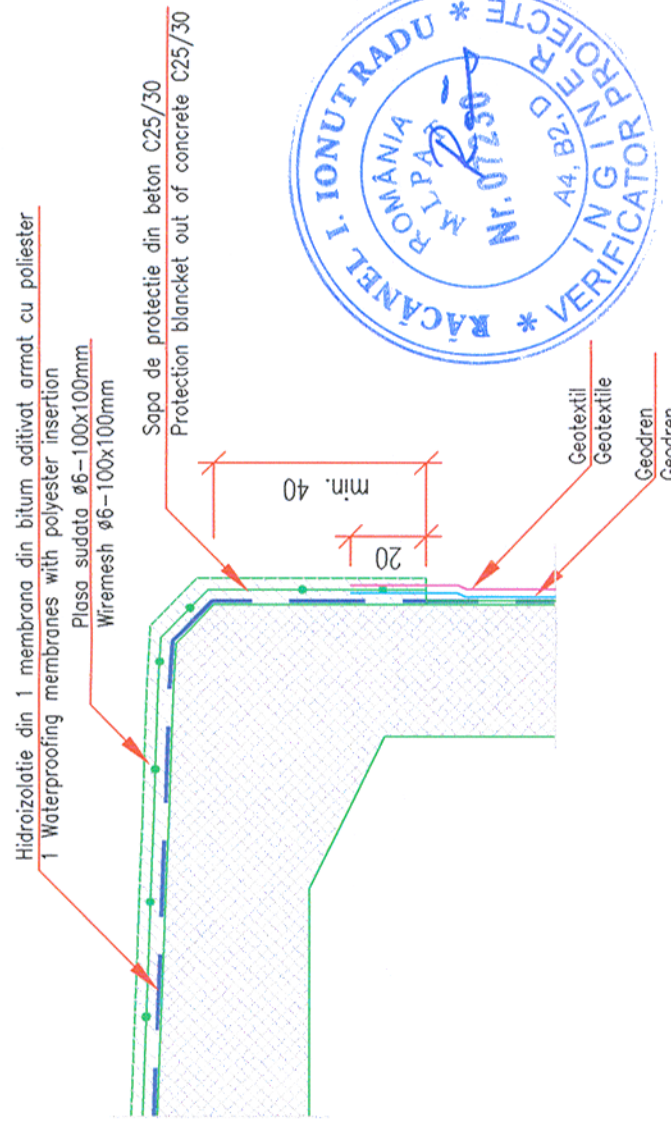

DETALIU DE PROTECTIE A HIDROIZOLATIEI  
WATERPROOFING PROTECTION DETAIL  
Sc.1:5

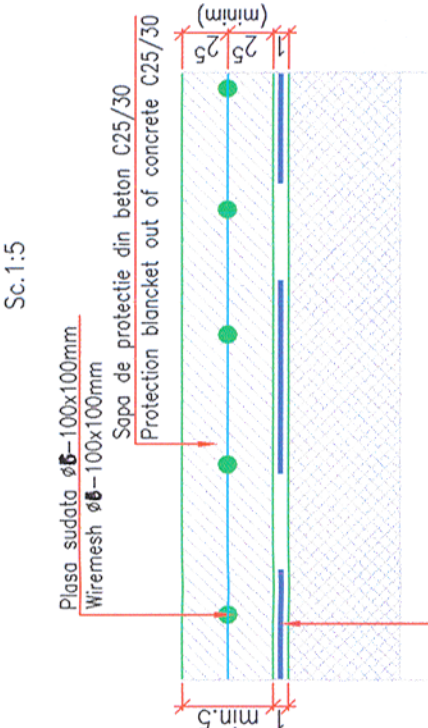

DETALIU DE RACORDARE A HIDROIZOLATIEI LA TIMPAN  
DETAIL FOR WATERPROOFING CONNECTION WITH INTEGRATED TYMPAN  
Sc.1:10

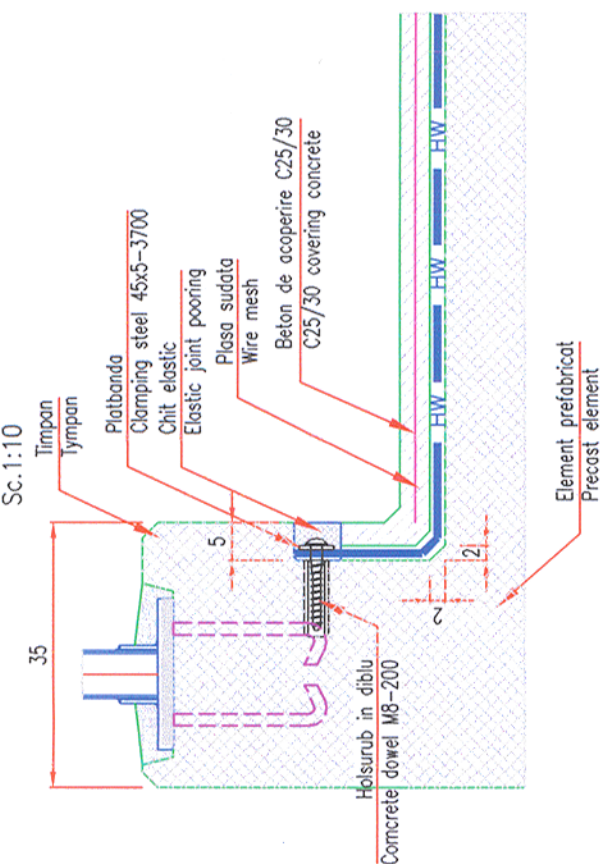

SISTEM DE DRENARE A APELOR DIN SPATELE PODETELOR  
SYSTEM FOR DRAINAGE THE WATER BEHIND THE CULVERTS  
Sc.1:50

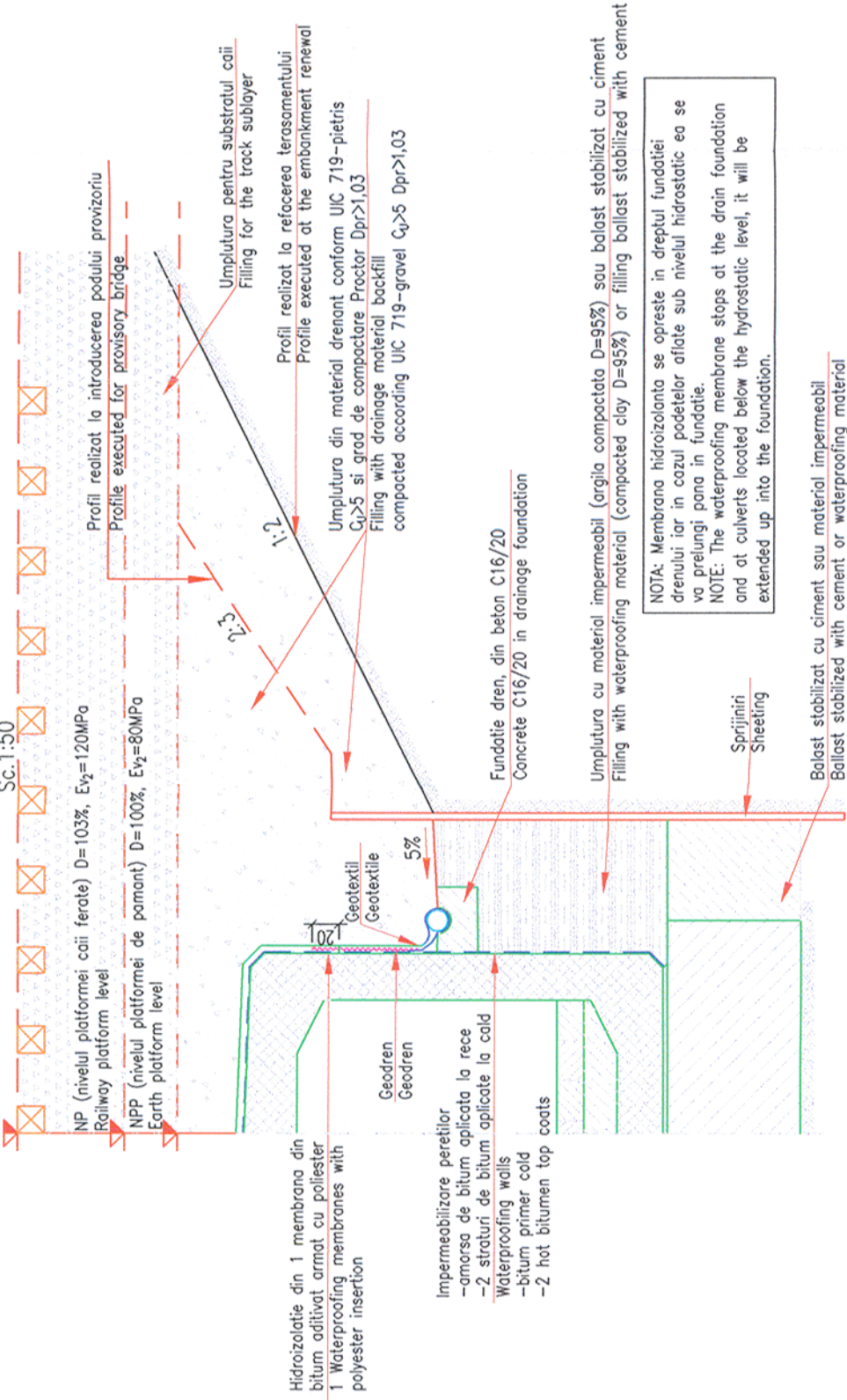

DETALIU CAP DREN  
DRAIN HEAD DETAIL  
Sc.1:20

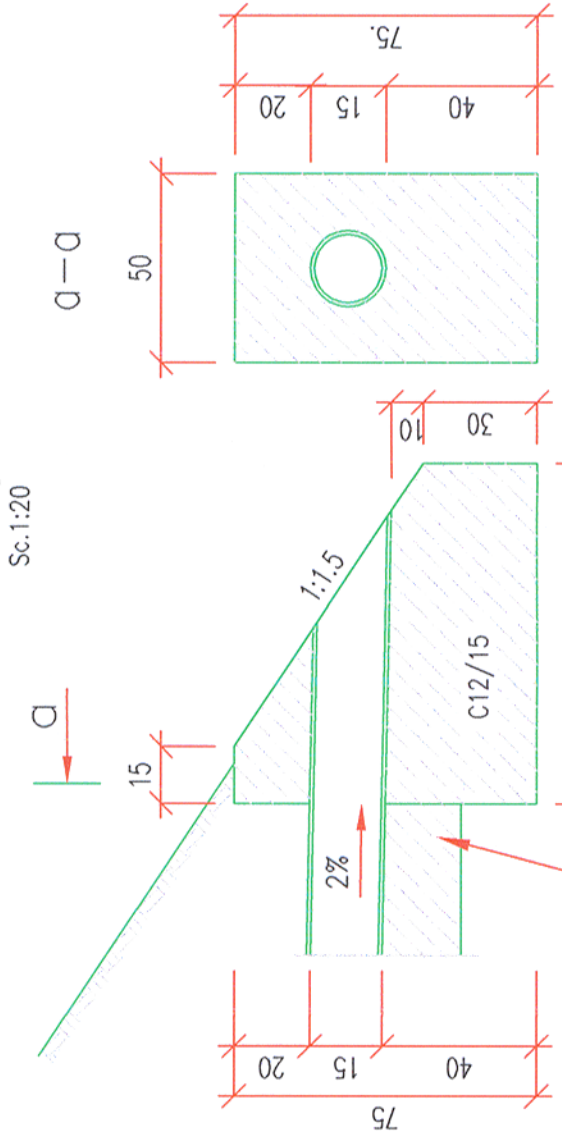

DETALIU TUB PVC  
PVC PIPE DETAIL  
Sc.1:10

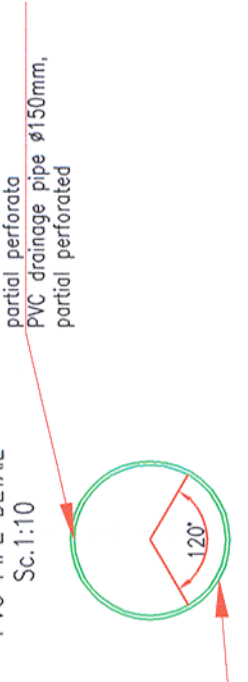

Prezentul plan anuleaza si inlocuieste versiunea anterioara  
This plan cancels and replaces previous version

Verificator / Expert Checker / Expert	Cerinta Requirement	Semnatura Signature	Referat / Expertiza Report / Expertise
		MINISTERUL TRANSPORTURILOR	
BENEFICIAR / BENEFICIARY : COMPANIA NAȚIONALĂ DE CĂI FERATE "CFR" SA			
PROIECTANT / DESIGNER: 			
Aprobat Approved	Sef de echipa Team leader	C. Teodorescu	Data Date 01.2013
Verificat Checked	Expert Cheie Key Expert	R. Tudorascu	01.2013
Subcontractant / Subcontractor 			
Aprobat Approved	Adjunct Sef de echipa Deputy Team leader	A.M. Baicu	01.2013
Proiectat Designed	Inginer Engineer	F. Ioanidi	01.2013
"Reabilitarea liniei c.f. Frontiera - Curtici - Simeria, parte componentă a coridorului IV Pan - European pentru circulația trenurilor cu viteză maximă de 160 km/h"		Project 9i 35311.1	
"Rehabilitation of the Railway Line Border - Curtici - Simeria, component Part of the IV Pan - European Corridor for the Trains Circulation with maximum speed of 160 km/h"		Faza / Phase: PTH+CS / TD+TS	
Denumire desen / Drawing name: <b>HIDROIZOLATIE SI SISTEM DE DRENARE PODETE WATERPROOFING AND DRAINAGE SYSTEM CULVERTS</b>			
Scara / Scale 1:50 1:20 1:10	Revizia / Revision 1/05.2013	Cod desen / Drawing Code PT.02.02.00.PO.002	Nr / No 02